

# CYLINDRICAL

FUSE LINKS & FUSE HOLDERS/BASES



## BAC

industrial open fuse bases  
for cylindrical fuse links

BAC

10x38



10x38



14x51



22x58

**PROTECTING  
THE WORLD**



10x38

RATED CURRENT  
32A

RATED VOLTAGE  
690V AC  
750V DC

MAXIMUM POWER DISSIPATION  
8W

PROTECTION INDEX  
IP00

STANDARDS  
IEC/EN 60269-1  
IEC/EN 60269-2



## Open type fuse bases for cylindrical fuse links

Industrial open fuse bases for industrial cylindrical fuse links size 10x38.

Specially suitable for semiconductor protection fuselinks that have a high dissipated power and need to be mounted on open fuseholders to facilitate the dissipation of heat.

Manufactured with a high quality materials

- Silver plated copper contacts.
- Plastic materials with high temperature resistance and self-extinguishable.
- All the materials are according to the European Directive RoHS.



For DIN rail mounting or with screw fixing.

Easy terminal connection.

Microswitch accessory for fuses with striker to monitor the fusion.

Manufactured according to IEC, EN standards.

## Warning of use

Installing or replacing of fuse links is only allowed by instructed specialized staff.



To avoid electrical risk, install the switchgear without voltage.

## Range

REFERENCE	DESCRIPTION	PACKING
		Uni /BOX
<b>451250</b>	10x38 BAC FUSE BASE 1P	6/120



## Technical data

Rated current	32A	
Rated voltage	690V AC	
	750V DC	
Maximum power dissipation	8W	
Protection index	IP00	
Rated impulse withstand voltage	6kV	
Ambient temperature of service	-20°C ... 70°C	
Storage temperature	-40°C ... 80°C	
Correction of the admissible current in function of the temperature	20° C	1
	30° C	0,95
	40° C	0,90
	50° C	0,80
	60° C	0,70
	70° C	0,60

## Dimensions

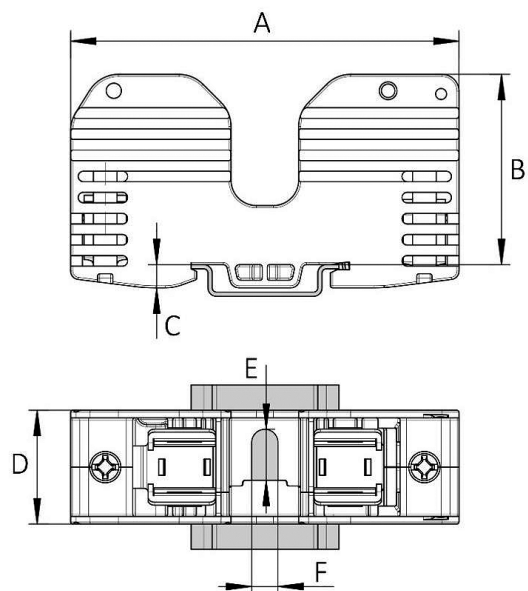

A	B	C	D	E	F
75	32,5	5,5	22	9	4,5

Weight 50gr

## Standards

IEC/EN 60269-1  
IEC/EN 60269-2



## Application characteristics

### Connecting wire

Copper wires only

METRIC	AWG	WIRING
0,75...25mm <sup>2</sup> Solid	4.....18 AWG Solid	
0,75...16mm <sup>2</sup> Stranded	6.....18 AWG Stranded	

### Wire-end terminals

The use of wire-end terminals may allow to increase the connecting wire section.

Wire-end terminals recommended mounting:

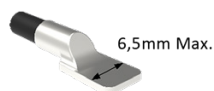

### Ferrules

It's recommended use of ferrules in wires with section  $\leq 2,5\text{mm}^2$



The product is delivered with the terminals opened and ready to connect

Tightening torque on terminals	2...2,5 Nm 18...22 lb.in
Screws with a combined head	SLOT + PH2
Screw fixing	M4 - 3 Nm For a correct functionality, use washers

### For mounting on DIN/EN standard rail DIN 46277/1-3 (EN50022)

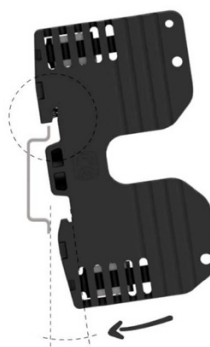

Insert the fuse holder on the DIN rail with a slight angle

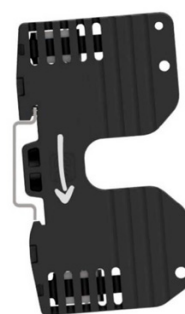

Fixed at the top, press down slightly to fix the bottom



The base is mounted on the rail.  
To disassemble, perform the same operations in reverse.



The clamping spring must be positioned at the top of the DIN rail

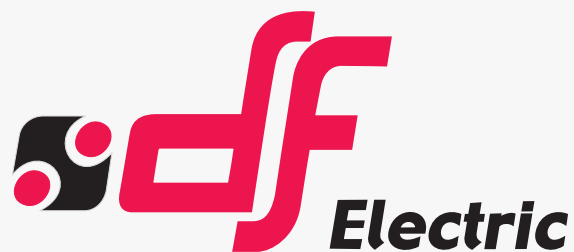

## PROTECTING THE WORLD

### HEAD OFFICE AND FACTORY

SILICI, 67-69  
08940 CORNELLA DE LLOBREGAT  
BARCELONA · SPAIN  
Tel. +34 93 377 85 85  
Fax +34 93 377 82 82

### INTERNATIONAL SALES

Tel. +34 93 475 08 64  
Fax +34 93 480 07 75  
export@dfelectric.es

### NATIONAL SALES

Tel. 93 475 08 64  
Fax 93 480 07 76  
comercial@dfelectric.es

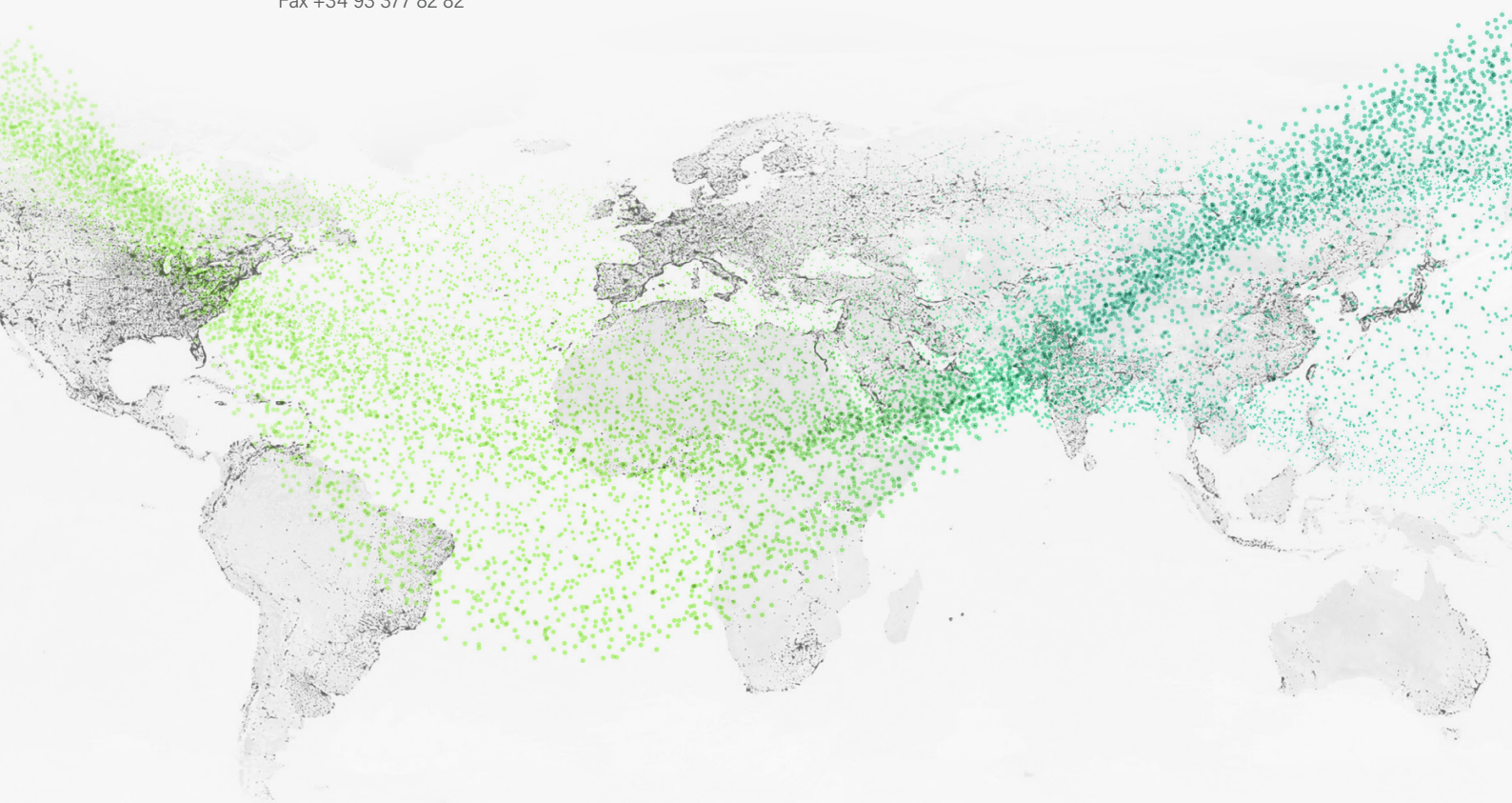

dfelectric.es



According to the waste of electrical and electronic equipment directive, electrical material should not be part of the usual waste. This symbol alerts users that these products should be recycled according to local environmental waste disposal regulations.



The "electro technical expert" logo marked on the products included in this data sheet indicates that the installation of these products must be carried out by expert personnel with specialized knowledge.



To prevent electrical hazards, carry out the installation without voltage.



**Safety notice**  
Please capture the following QR code and read our safety notice carefully before installing our products.



The data reflected in this technical record are subject to the correct installation of the product in accordance with manufacturer's instructions, relevant installation standards and professional practices, maintained and used in applications for which they were made.

The products described in this document have been designed, developed and tested in accordance with specific standard. They are considered components that are integrated as part of installation, machine or equipment. The correct general operation of the referred product is responsibility of the manufacturer of the installation, machine or equipment.

DF ELECTRIC cannot guarantee the characteristics of an installation, machine or equipment that has been designed by a third party. Once a product has been selected, the user must verify that it is appropriate for its application, through the verifications and/or tests that it deems appropriate.

DF ELECTRIC retains the right to change the dimensions, specifications, materials or design of its products at any time with or without notice.

©2022 DF Electric. All rights reserved